

## Braukmann SV300

Einbauanleitung • Installation Instructions • Instructions de montage • Istruzioni di montaggio

### E1

Bauteile • Components • Pièces • Componenti

①= Pilotventil  
Pilot valve  
Vanne pilote  
Valvola pilota

②= Filtereinsatz  
Filter insert  
Garniture de filtration  
Inserto filtro

③= Absperr-Kugelhahn  
Manual ball valve  
Clapet à bille  
Valvola di intercettazione a sfera

④= Nadelventil  
Needle Valve  
Soupape d'aiguille  
Valvola a spillo

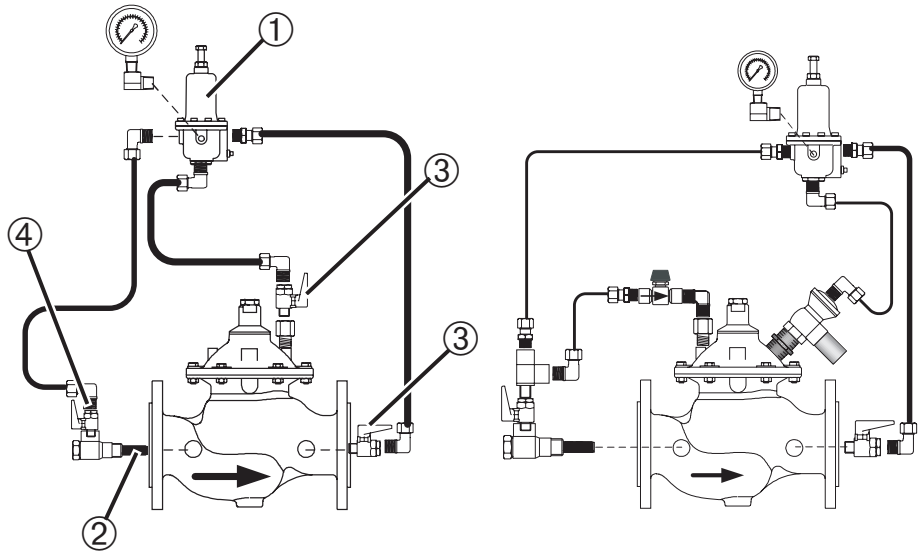

### E2

Einbau • Installation • Installation • Installazione

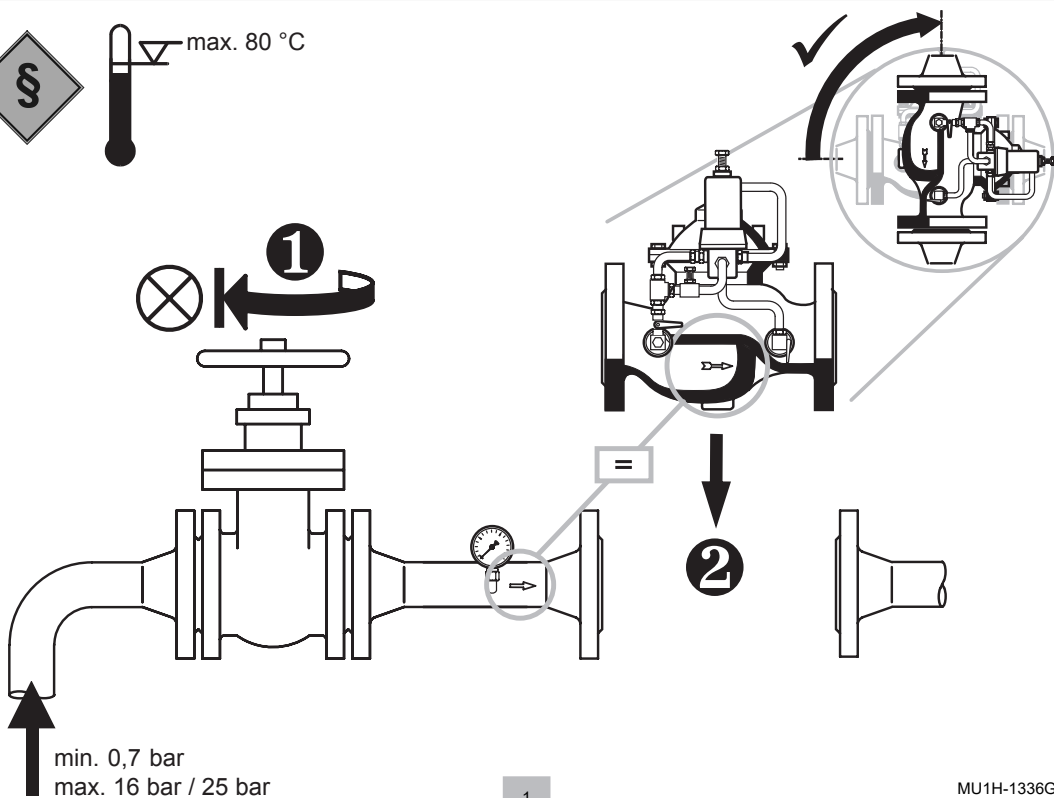
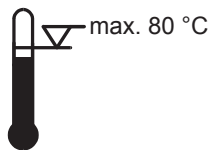

# E3

## Inbetriebnahme • Commissioning • Mise en service Messa in servizio

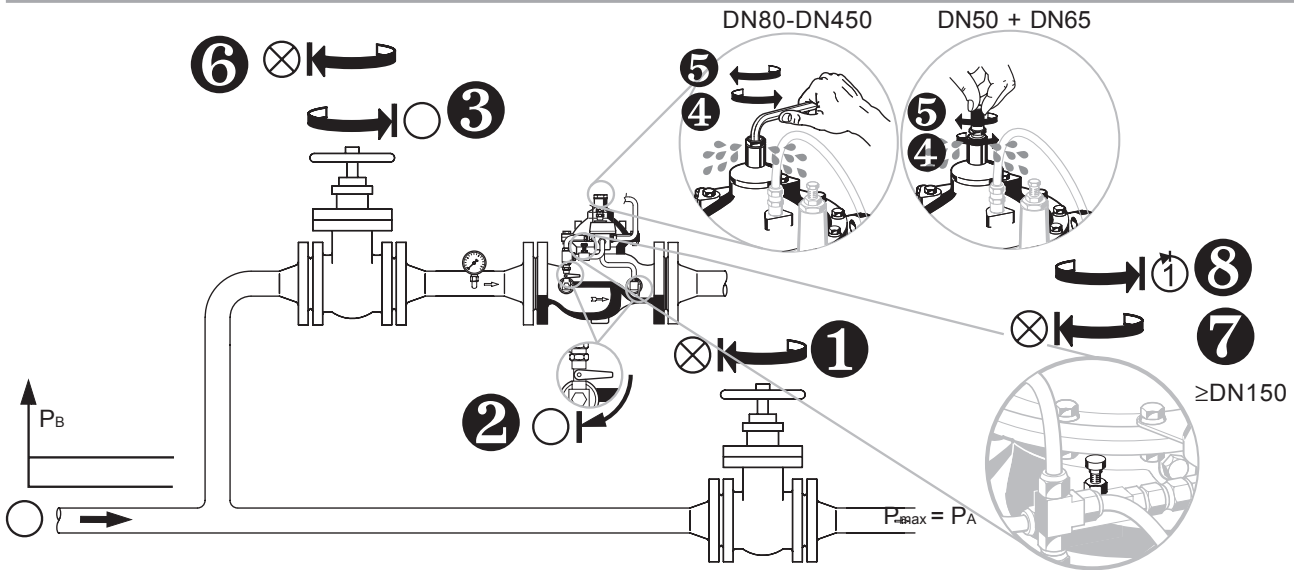

$P_B$  = Betriebsdruck  
 $P_B$  = Operating pressure  
 $P_B$  = Pression de service  
 $P_B$  = Pressione di esercizio

$P_A$  = Ansprechdruck  
 $P_A$  = Opening pressure  
 $P_A$  = Pression de levée  
 $P_A$  = Pressione di apertura

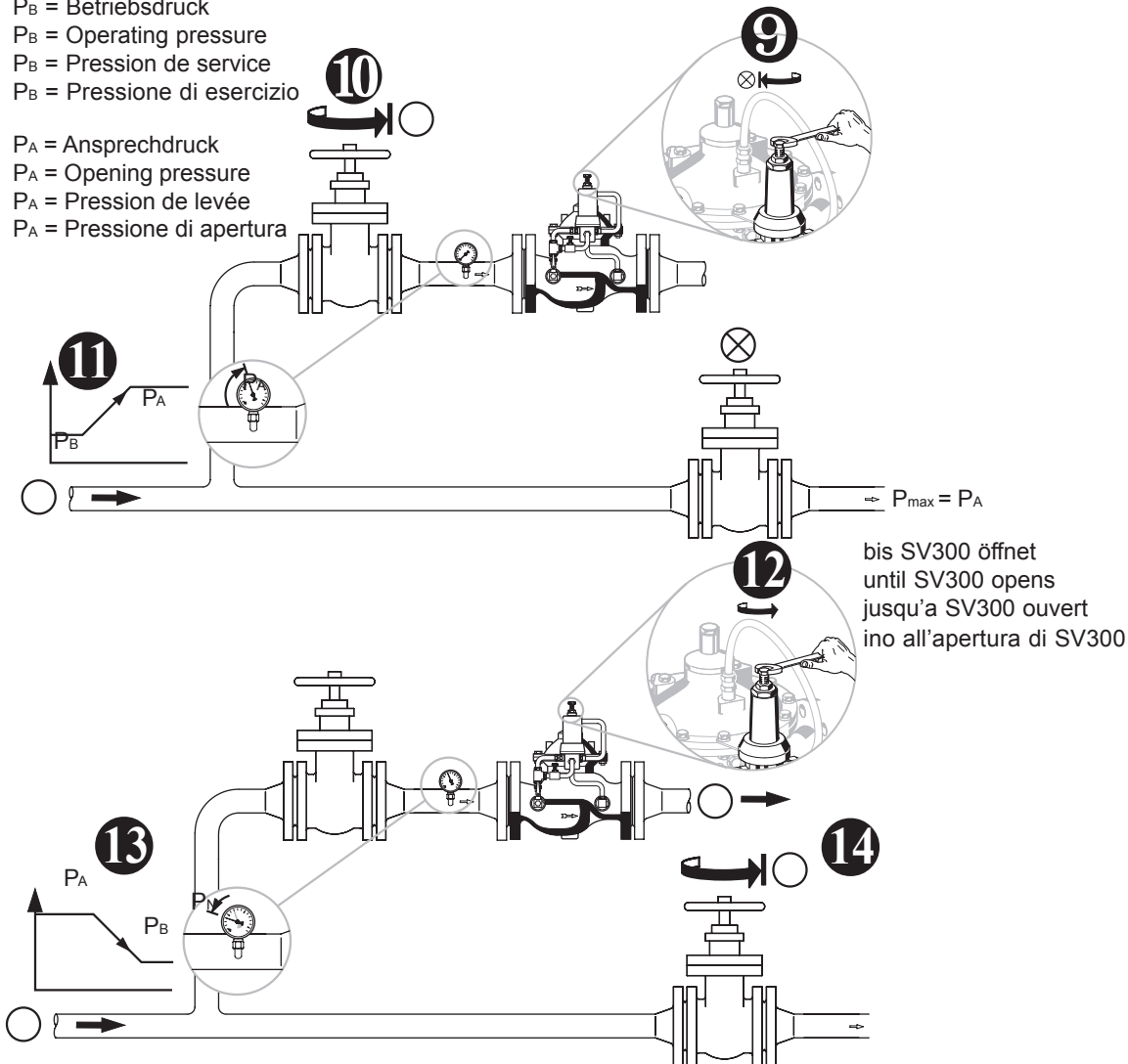

bis SV300 öffnet  
 until SV300 opens  
 jusqu'à SV300 ouvert  
 ino all'apertura di SV300



Manufactured for  
 and on behalf of  
 Pittway Sàrl, Z.A., La Pièce 4,  
 1180 Rolle, Switzerland  
 by its authorised representative  
 Ademco 1 GmbH

For more information  
[homecomfort.resideo.com/europe](http://homecomfort.resideo.com/europe)  
 Ademco 1 GmbH, Hardhofweg 40,  
 74821 MOSBACH, GERMANY  
 Phone: +49 6261 810  
 Fax: +49 6261 81309