

# resideo

## SLI/SBI/SBIA

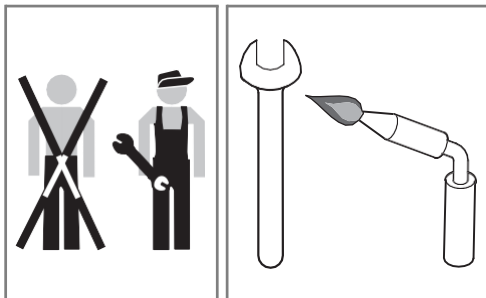

§ EN 378		HFKW (HFC) HFCKW (HCFC)	 R12 R502 NH3

Typ	PS	PF	TS
SLI 6; SLI 1/4; SLI 10; SLI 3/8; SLI 12; SLI 1/2; SLI 15; SLI 16 (5/8)	47 bar(a)	51,7 bar(a)	≤ 80 °C
SLI 18; SLI 3/4; SLI 22 (7/8); SBI; SBIA	36 bar(a)	39,6 bar(a)	
SLI 28; SLI 1 1/8	35 bar(a)	38,5 bar(a)	

R22	< 30 ppm	30 – 150 ppm	> 150 ppm
R134a	< 60 ppm	60 – 100 ppm	> 100 ppm
R404A	< 20 ppm	20 – 100 ppm	> 100 ppm
R407C	< 20 ppm	20 – 130 ppm	> 130 ppm
R410A	< 40 ppm	40 – 150 ppm	> 150 ppm
R507A	< 20 ppm	20 – 100 ppm	> 100 ppm

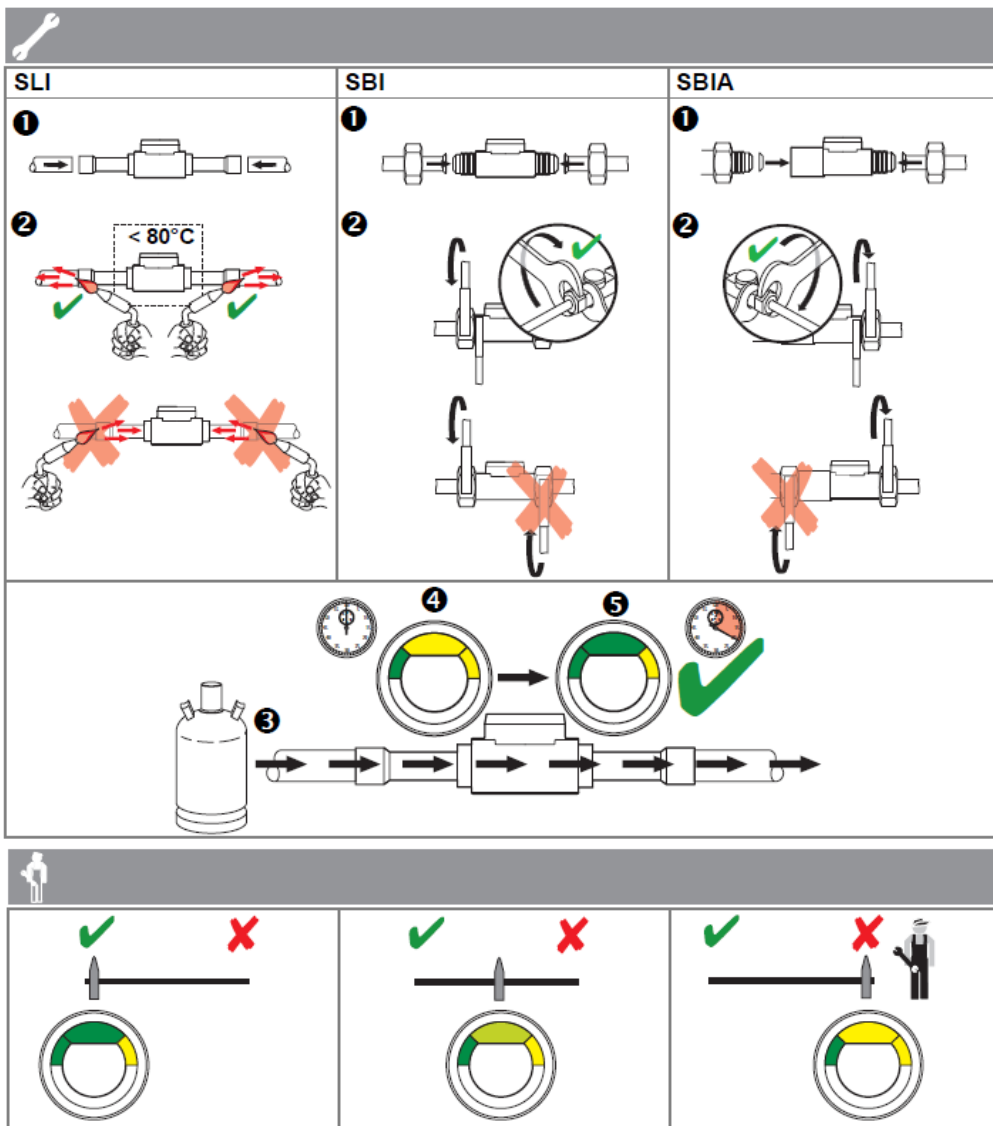

# resideo

Resideo Pittway Sàrl  
 Z.A. La Pièce 4  
 1180 Rolle  
 Switzerland