



EW480 Series

Magnetic Inductive Flow Meters

DN100...250 for Heating and Chilled Water Applications

APPLICATION

Honeywell Home EW480 Series magnetic inductive flow meters are used for flow measurement in hydronic heating, cooling or air conditioning systems. They consist of a flow sensor with preassembled converter and are typically used with an EW500 Series energy calculator for heat energy metering.

APPROVALS

- MID approved (MI004)
- CE marked

SPECIAL FEATURES

- Horizontal and riser installation position
- No pressure loss
- Rugged design
- Indifferent to dirt in the system
- Sizes > DN250 available on request

TECHNICAL DATA

General Specifications	
Sizes:	DN100-DN250 Qp250-1600
Protection class:	IP67
Measuring process:	Magnetic inductive
Accuracy	0.8 %
Operating Conditions	
Medium:	Heating water according to VDI 2035 Chilled water
Minimum conductivity:	5µS / cm
Operating temperature:	-20 - 100 °C
Ambient temperature:	-10 - 50 °C
Operating pressure:	PN16
Installation position:	horizontal or vertical (riser)
Power supply:	100-240 Vac / 44-66 Hz
Suitable calculator:	EW5001CDZ



CONSTRUCTION

Overview	Components	Materials
	1 Terminal cover	Nylon reinforced with 15% fibreglass
	2 Cable grommets	-
	3 Type plate flow sensor (on backside)	-
	4 Sensor housing with flanges to EN 1092-2 PN16	Carbon steel painted green
	5 Lining	PTFE
	6 Type plate converter	-
	7 Converter housing	Nylon reinforced with 15% fibreglass
Not depicted components:		
Electrodes (two measuring and one ground)		AISI 316

TRANSPORTATION AND STORAGE

EW480 is a precision measuring instrument and must be treated accordingly. The following parameters apply during transportation and storage:

- Keep parts in their original packaging and unpack them shortly before use
- Units should only be transported in their original packaging
- Appropriate lifting gear must be used where applicable
- Units should be handled carefully right way up and must not be dropped
- Units should be stored in a clean, dry and dust free environment

Parameter	Value
Environment:	Clean and dust free
Min. ambient temperature:	-10 °C
Max. ambient temperature:	50 °C
Min. ambient relative humidity:	0 %
Max. ambient relative humidity:	100 %

INSTALLATION GUIDELINES

Setup requirements

- Observe the correct flow direction. Flow direction is indicated on the typeplate of the flow sensor where the flow direction is from - to +
- Calming legs with a minimum length of 3 x DN are required upstream and 2 x DN downstream of the meter
- All sizes may be installed in either horizontal or vertical position where vertical installation is only suitable for risers, but not for fallpipes
- During measurement the meter must be completely filled with water
- For installation in long pipes use anti vibration joints
- Flow meters with a weight of 20 kg and more are equipped with eye bolts for lifting. The eye bolts only support the weight of the meter
- The flow meter must be grounded. In case of insulated pipe with metallic rings between the flanges. In case of pipe with cathodic protection additionally with bushings to insulate the flange bolts

TECHNICAL CHARACTERISTICS

Flow Data

Nominal size diameter:	DN	100	125	150	200	250
Flow rates according to MID						
Minimum (q _i):	m ³ /h	2.5	4	6.3	10	16
Nominal (q_p)	m³/h	250	400	630	1000	1600
Maximum (q _s):	m ³ /h	312.5	500	787.5	1250	1938
Dynamic range:	q _p /q _i	100:1	100:1	100:1	100:1	100:1

DIMENSIONS

Converter

Overview

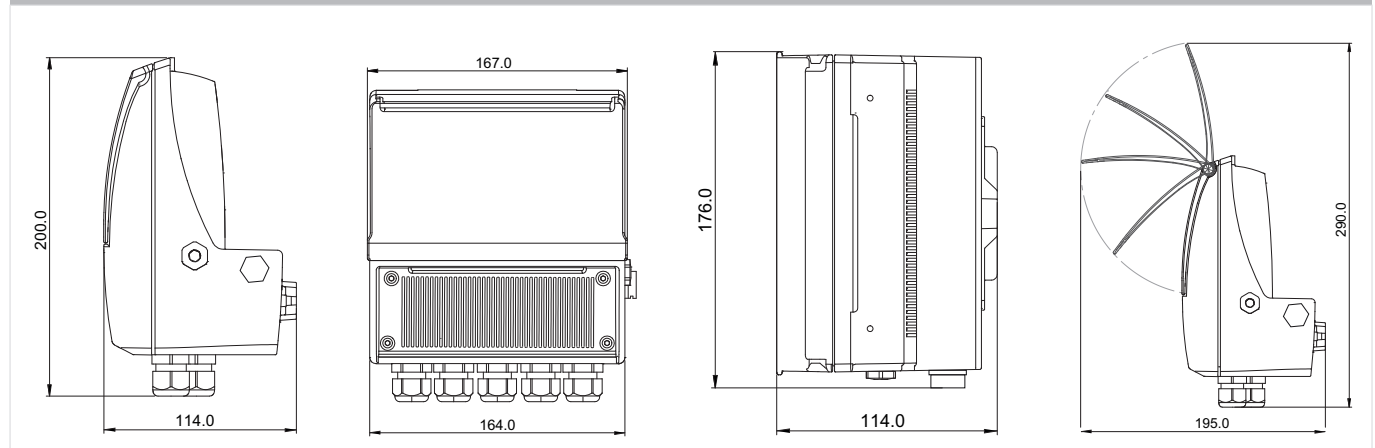

Flow Sensor

Overview

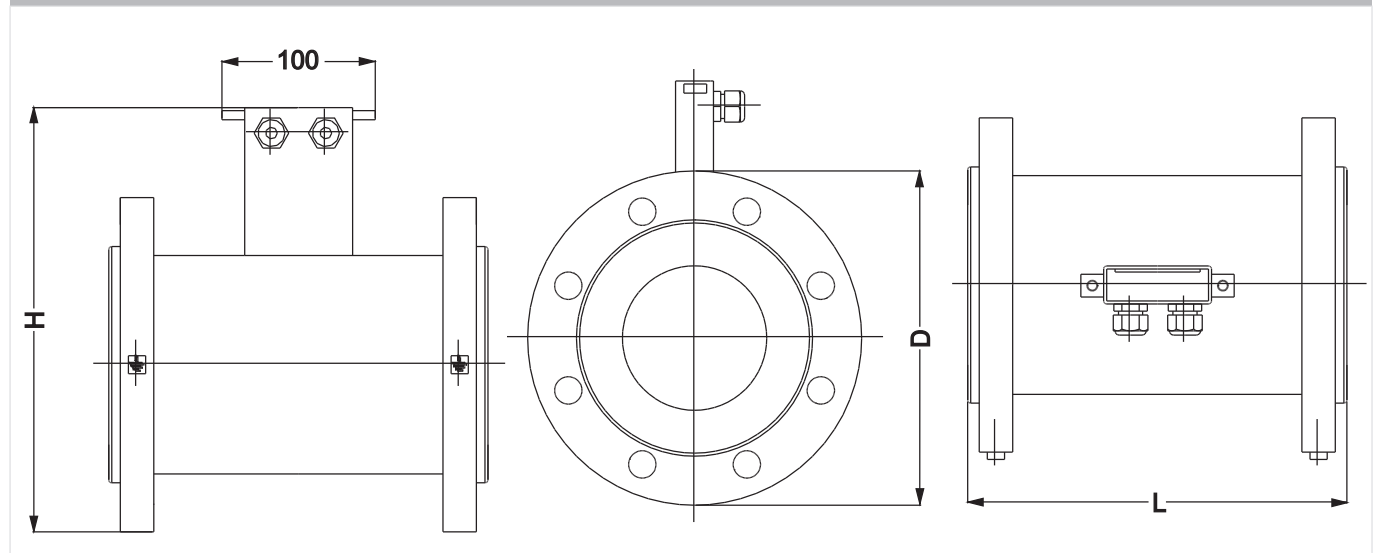

Nominal size diameter:	DN	100	125	150	200	250
Dimensions:	L	250	250	300	350	450
	H	283	313	344	399	460
Flanges:	D	220	250	285	340	405
	Bolt circle Ø	180	210	240	295	355
	Bolts	8 x M16	8 x M16	8 x M20	12 x M20	12 x M24
Weight:	kg	20	24	35	45	65

Note: All dimensions in mm unless stated otherwise

ORDERING INFORMATION

The following tables contain all the information you need to make an order of an item of your choice. When ordering, please always state the type, the ordering or the part number.

Item:	DN size:	Nominal flow qp m ³ /h:	Length mm:	Pulse value:	Ordering Number	Suitable calculator:
EW4801A MAG flow meters for heating and chilled water	100	250	250	10 litres	EW4801AP7323	EW5001CDZ
	125	400	250		EW4801AP8123	
	150	630	300		EW4801AP8523	
	200	1000	350		EW4801AP8923	
	250	1600	450		EW4801AP9123	

For more information

homecomfort.resideo.com/europe



Ademco 1 GmbH
Hardhofweg 40
74821 MOSBACH
GERMANY
Phone: +49 6261 810
Fax: +49 6261 81309

Manufactured for and on behalf of the
Pittway Sàrl, La Pièce 4, 1180 Rolle, Switzerland
by its Authorised Representative Ademco 1 GmbH
ENOH-0490GE23 R0520

Subject to change

© 2020 Pittway Sàrl. All rights reserved.
This document contains proprietary information of
Pittway Sàrl and its affiliated companies and is
protected by copyright and other international laws.
Reproduction or improper use without specific
written authorisation of Pittway Sàrl is strictly
forbidden. The Honeywell Home trademark is used
under license from Honeywell International Inc.

Honeywell Home